

# How to use the multi-stage gas rice cooker

## Rice and water quantities

Add soaked, uncooked rice and water to the pot according to the quantity marks displayed on the pot.  
If the rice is partially undercooked (especially in the center), add a little more water than usual or put in a little less rice.

### Rice conversion table

Quantity (serving)	Rice quantity (uncooked rice)	Mark (soaked rice)	Rice cooking time (including 15 minutes standing)		Select dish (white rice)
			Aluminum pot	Stainless steel pot	
50	7.5kg		35minutes	34minutes	High
40	6.0kg		34minutes	34minutes	Standard
30	4.5kg		32minutes	32minutes	
20	3.0kg	No mark in the pot	31minutes	31minutes	Low

## Pot installation

Face the pot handle forward and push until the pot touches the wall, then slowly close the door.

## Cooking rice

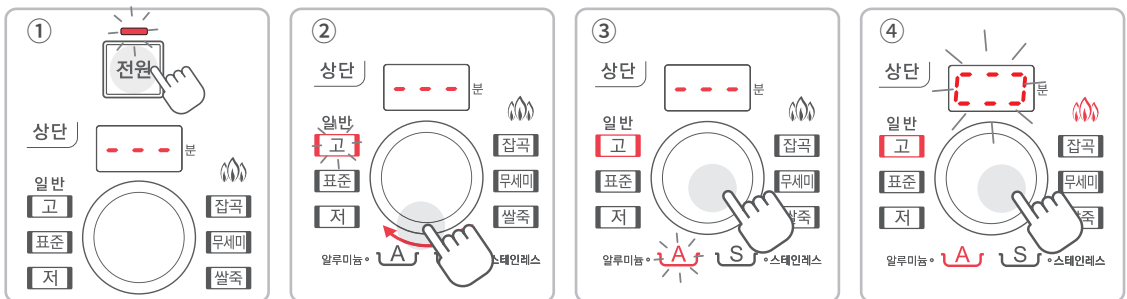

- ① Press the [Power] button to turn on the power light. ( - - - ) is shown on the display.
- ② Turn the [Selection switch] to select the type of rice.
- ③ Press and hold the [Selection switch] to select the type of rice.
- ④ When you release the [Selection switch], rice cooking starts automatically.

## Using the rice cooker safely

---

### Clean the heater

- Always keep the heater clean. Never clean around the heater with water.
- Always keep the inside and outside of the pot clean.
- Please keep the pot inside and outside cleaned. Especially, please keep the outside heat sensor contacts cleaned from oil stain.

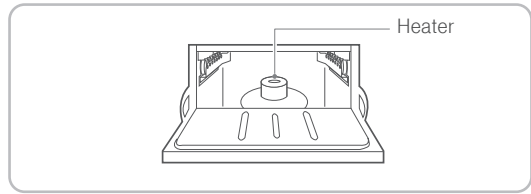

### Water temperature to use

- Use cold water to wash rice or add water. The rice may not cook correctly if you use warm water.

### Caution with moisture

- Do not put wet containers on top of the controls.
- Do not spray water on the controls while cleaning.

### Pot discoloration

- If you put only water into the aluminum pot and boil it, the pot may become discolored. However, it will still be usable.
- If you are making rice more than once in a row, rinse the pot clean and refill it with cold water, then let it stand for about 5 minutes with the door closed before starting to make rice after the first time.

## Automatic detection control

---

Automatic detection control indicator	Contents	Actions
E11	If the burner is not starting correctly	• Check that the central gas valve is open.
E12	If there is burning while making rice	
E24, E28 E31, E52 E71, E72	If there is an electrical circuit problem	• Contact our customer service center when you need maintenance.