

How to use the gas range

Gas range manual

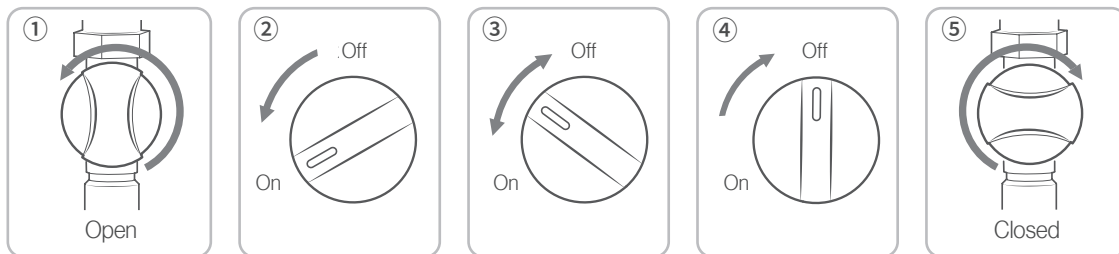

- ① Turn the gas valve to the left to open the gas line.
- ② To turn on the stove, press and turn a knob until it reaches "on."
- ③ Control flames by turning the knob.
- ④ To turn off the stove, turn it all the way back off until it reaches "off."
- ⑤ Turn the gas valve to the right to close the gas line.

Safety precautions

• Burners with inbuilt overheating prevention sensors

The burners are safer than other existing ones with inbuilt sensors which detect temperature of the bottom of cookware and turn off the gas flow before the temperature reaches a dangerous level, the burners are safer than existing ones.

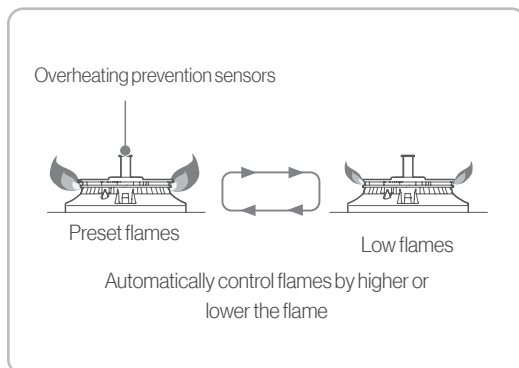

• Automatic flame control function

When the sensor detects high heat, it lowers the flame with a beeping sound and small snapping sound. When the temperature becomes low and safe, the sensor higher the flame as it is set.

Replacing batteries

- Make sure replace all two alkaline batteries to new ones. (1.5V LR20 D)
- Do not use a used battery and a newly replaced battery together. It will shorten the lifespan of the battery.

How to Replace Batteries

- Lift the handle on the battery case upward (①), then slowly turn it forward (②).

