

How to use the gas range

Gas range manual

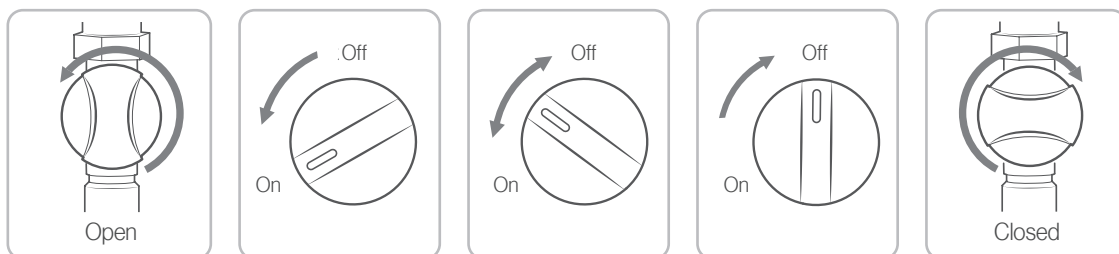

- ① Turn the gas valve to the left to open the gas line.
- ② To turn on the stove, press and turn a knob until it reaches "on."
- ③ Control flames by turning the knob.
- ④ To turn off the stove, turn it all the way back off until it reaches "off."
- ⑤ Turn the gas valve to the right to close the gas line.

How to Use the Simple Cook Feature (e.g. to Automatically Cook Ramen)

- ① Add water to a pot and put it on the large left burner.
- ② Turn the knob for the large left burner to cook with high heat.
- ③ When the water is boiling and you hear a sound (beep-beep, beep-beep, beep-beep), add the noodles and soup.
- ④ Press the Simple Cook button and select your desired time.
 - Each time the Simple Cook button is pressed, LEDs are illuminated in sequence and a sound is played.
 - If there is no further operation within 5 seconds after the button is first pressed, the selection is automatically confirmed and cannot then be changed.
- ⑤ When the set cooking time is up, there is a sound (beep, beep-beep) and the burner automatically turns off.
 - Be sure to turn the ignition knob to off once cooking is complete.

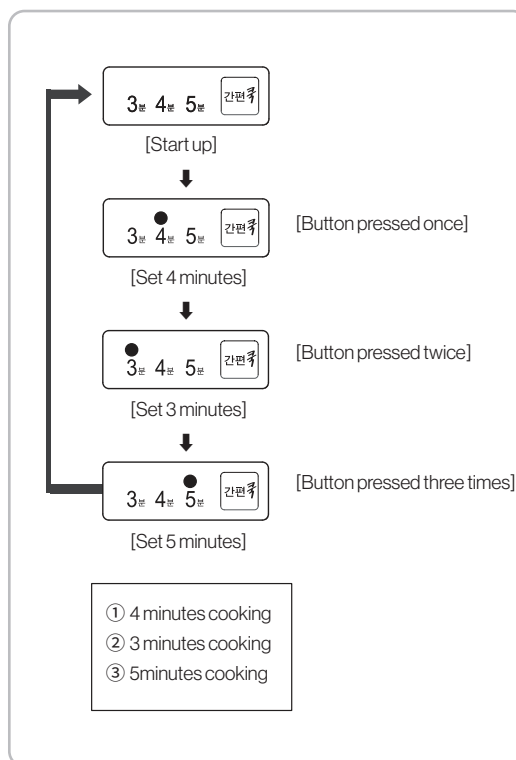

Safety precautions

- **Burners with inbuilt overheating prevention sensors**

The burners are safer than other existing ones with inbuilt sensors which detect temperature of the bottom of cookware and turn off the gas flow before the temperature reaches a dangerous level, the burners are safer than existing ones.

- **Automatic flame control function**

When the sensor detects high heat, it lowers the flame with a beeping sound and small snapping sound. When the temperature becomes low and safe, the sensor higher the flame as it is set.

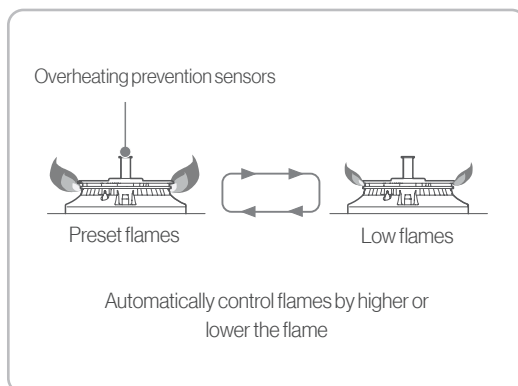

Replacing batteries

- Make sure replace all two alkaline batteries to new ones. (1.5V LR20 D)
- Do not use a used battery and a newly replaced battery together. It will shorten the lifespan of the battery.

How to Replace Batteries

- ① Press on the battery case and release when you hear a “click”.
- ② Hold the battery case and slowly pull it.
- ③ Remove the 2 batteries and replace them both with new ones.
- ④ Press on the battery case until you hear a “click”.

